

# TECHNICAL DATA SHEET



|                    |                                                                                                                                                                                                                                                             |          |
|--------------------|-------------------------------------------------------------------------------------------------------------------------------------------------------------------------------------------------------------------------------------------------------------|----------|
| Type               | <b>DucoGrille Classic F 50Z</b>                                                                                                                                                                                                                             |          |
| DESCRIPTION        | Window louvre, applicable in aluminium, PVC or timber windows                                                                                                                                                                                               |          |
| SHAPE OF BLADE     | 50Z                                                                                                                                                                                                                                                         |          |
| PITCH              | 65 mm                                                                                                                                                                                                                                                       |          |
| FRAME WIDTH        | 39 mm                                                                                                                                                                                                                                                       |          |
| GLASS THICKNESS    | 28 mm                                                                                                                                                                                                                                                       |          |
| FRAME DEPTH        | 77 mm                                                                                                                                                                                                                                                       |          |
| MIN. DIMENSIONS    | Width 300mm, Height 350mm. Exception on request.                                                                                                                                                                                                            |          |
| MESH               | <ul style="list-style-type: none"> <li>- standard with insectmesh 2.3 x 2.3 mm</li> <li>- optional without mesh</li> <li>- optional with bird mesh 6 x 6 mm</li> <li>- optional with bird mesh 20 x 20 mm</li> </ul>                                        |          |
| DRIP TRAY PROFILE  | standard without drip tray, drainage via frame profile                                                                                                                                                                                                      |          |
| MATERIAL           | Aluminium : EN AW-6063 T66 (EN 573-3)<br>Profile thickness : min. 1,5mm<br>Thermoplastic parts : Clips<br>Polyamide PA 6,6 -reinforced with glass fibre                                                                                                     |          |
| SURFACE TREATMENT  | <ul style="list-style-type: none"> <li>- standard aluminium anodised (15-20µm) according Qualanod</li> <li>- polyester powder coated (60-80µm) according Qualicoat Seaside type A</li> <li>- specific RAL codes and/or textured paint on request</li> </ul> |          |
| VISUAL FREE AREA   | 75%                                                                                                                                                                                                                                                         |          |
| PHYSICAL FREE AREA | 47%                                                                                                                                                                                                                                                         |          |
| AIR FLOW DATA      | (EN13030)                                                                                                                                                                                                                                                   | standard |
|                    | Ce                                                                                                                                                                                                                                                          | 0,232    |
|                    | K-factor intake                                                                                                                                                                                                                                             | 18,58    |
|                    | Cd                                                                                                                                                                                                                                                          | 0,263    |
|                    | K-factor exhaust                                                                                                                                                                                                                                            | 14,46    |
| WATER RESISTANCE   | (EN13030)                                                                                                                                                                                                                                                   | standard |
|                    | v = 0 m/s                                                                                                                                                                                                                                                   | C        |
|                    | v = 0,5 m/s                                                                                                                                                                                                                                                 | C        |
|                    | v = 1 m/s                                                                                                                                                                                                                                                   | C        |
|                    | v = 1.5 m/s                                                                                                                                                                                                                                                 | D        |
|                    | v = 2 m/s                                                                                                                                                                                                                                                   | D        |
|                    | v = 2.5 m/s                                                                                                                                                                                                                                                 | D        |
|                    | v = 3 m/s                                                                                                                                                                                                                                                   | D        |
| v = 3,5 m/s        | D                                                                                                                                                                                                                                                           |          |

3

2

1

D

D

C

C

B

B

A

A

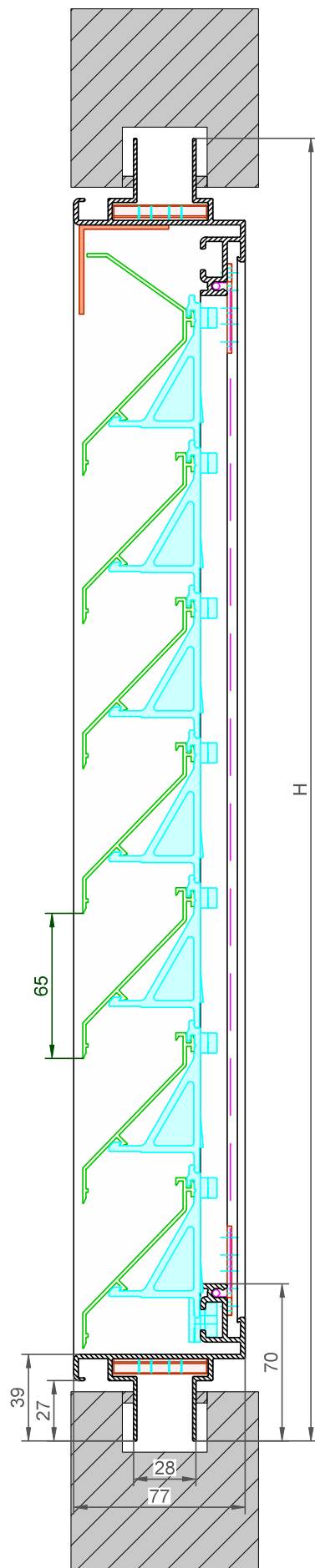
DucoGrille Classic **F50Z-65**

Datum : 22/03/2023

Schaal : 1:2

**DUCO**  
Ventilation & Sun Control

Bedrijvenlaan 2 - 8630 VEURNE  
tel. 0032-58/330066 - fax.0032-58/330067  
email: info@duco.eu www.duco.eu

Deze tekening is eigendom van Duco Projects en mag niet gekopieerd  
noch getoond worden aan derden zonder schriftelijke toestemming

Tol. : ISO 2768-mK

Getekend : SDN/JHX

Mat. :

Ref nr. :

Formaat : A3



omtrek

gewicht

lakoppervl.

Tekening nr. :

mm

kg/m

dm²/m

**DGC-F50Z-65**

3

2

1