

# TECHNICAL DATA SHEET



Type	<b>DucoGrille Classic G 20Z</b>																			
DESCRIPTION	Louvre "build-in" wall grille																			
SHAPE OF BLADE	20Z																			
PITCH	35 mm																			
FRAME WIDTH	25 mm																			
EQUAL LEG OUTER FRAME	19 mm																			
FRAME DEPTH	36 mm																			
MIN. DIMENSIONS	Width 200mm, Height 200mm. Exception on request.																			
MESH	<ul style="list-style-type: none"> <li>- standard with insectmesh 2.3 x 2.3 mm</li> <li>- optional without mesh</li> <li>- optional with bird mesh 6 x 6 mm</li> <li>- optional with bird mesh 20 x 20 mm</li> </ul>																			
DRIP TRAY PROFILE	extra drip tray on the back of the frame possible as an option																			
MATERIAL	Aluminium : EN AW-6063 T66 (EN 573-3) Profile thickness : min. 1,5mm Thermoplastic parts : Clips Polyamide PA 6,6 -reinforced with glass fibre																			
SURFACE TREATMENT	<ul style="list-style-type: none"> <li>- standard aluminium anodised (15-20µm) according Qualanod</li> <li>- polyester powder coated (60-80µm) according Qualicoat Seaside type A</li> <li>- specific RAL codes and/or textured paint on request</li> </ul>																			
VISUAL FREE AREA	63%																			
PHYSICAL FREE AREA	41%																			
AIR FLOW DATA	<table border="1"> <thead> <tr> <th>(EN13030)</th> <th>standard</th> </tr> </thead> <tbody> <tr> <td>Ce</td> <td>0,203</td> </tr> <tr> <td>K-factor intake</td> <td>24,27</td> </tr> <tr> <td>Cd</td> <td>0,174</td> </tr> <tr> <td>K-factor exhaust</td> <td>33,03</td> </tr> </tbody> </table>		(EN13030)	standard	Ce	0,203	K-factor intake	24,27	Cd	0,174	K-factor exhaust	33,03								
(EN13030)	standard																			
Ce	0,203																			
K-factor intake	24,27																			
Cd	0,174																			
K-factor exhaust	33,03																			
WATER RESISTANCE	<table border="1"> <thead> <tr> <th>(EN13030)</th> <th>standard</th> </tr> </thead> <tbody> <tr> <td>v = 0 m/s</td> <td>C</td> </tr> <tr> <td>v = 0,5 m/s</td> <td>C</td> </tr> <tr> <td>v = 1 m/s</td> <td>C</td> </tr> <tr> <td>v = 1.5 m/s</td> <td>D</td> </tr> <tr> <td>v = 2 m/s</td> <td>D</td> </tr> <tr> <td>v = 2.5 m/s</td> <td>D</td> </tr> <tr> <td>v = 3 m/s</td> <td>D</td> </tr> <tr> <td>v = 3,5 m/s</td> <td>D</td> </tr> </tbody> </table>		(EN13030)	standard	v = 0 m/s	C	v = 0,5 m/s	C	v = 1 m/s	C	v = 1.5 m/s	D	v = 2 m/s	D	v = 2.5 m/s	D	v = 3 m/s	D	v = 3,5 m/s	D
(EN13030)	standard																			
v = 0 m/s	C																			
v = 0,5 m/s	C																			
v = 1 m/s	C																			
v = 1.5 m/s	D																			
v = 2 m/s	D																			
v = 2.5 m/s	D																			
v = 3 m/s	D																			
v = 3,5 m/s	D																			

3

2

1

D

D

C

C

B

B

A

A

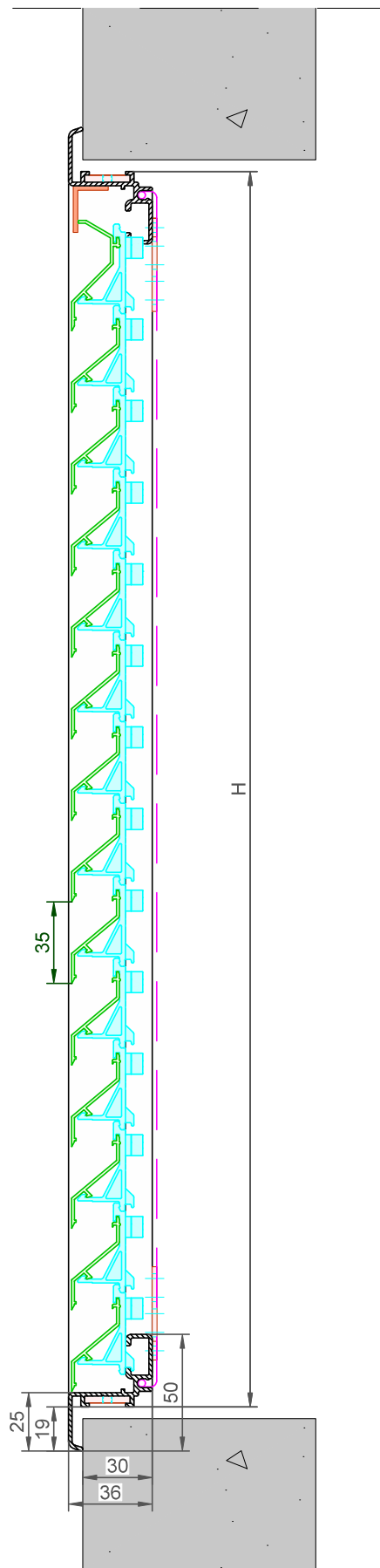
DucoGrille Classic **G20Z**

Datum : 29/08/2022

Schaal : 1:2

**DUCO**  
Ventilation & Sun Control

Bedrijvenlaan 2 - 8630 VEURNE  
tel. 0032-58/330066 - fax.0032-58/330067  
email: info@duco.eu www.duco.eu  
Deze tekening is eigendom van Duco Projects en mag niet gekopieerd  
noch getoond worden aan derden zonder schriftelijke toestemming

Tol. : ISO 2768-mK

Getekend : SDN/JHX

Mat. :

Ref nr. :

Formaat : A3



omtrek

gewicht

lakoppervl.

Tekening nr. :

mm

kg/m

dm²/m

**DGC-G20Z**

3

2

1