

TECHNICAL DATA SHEET

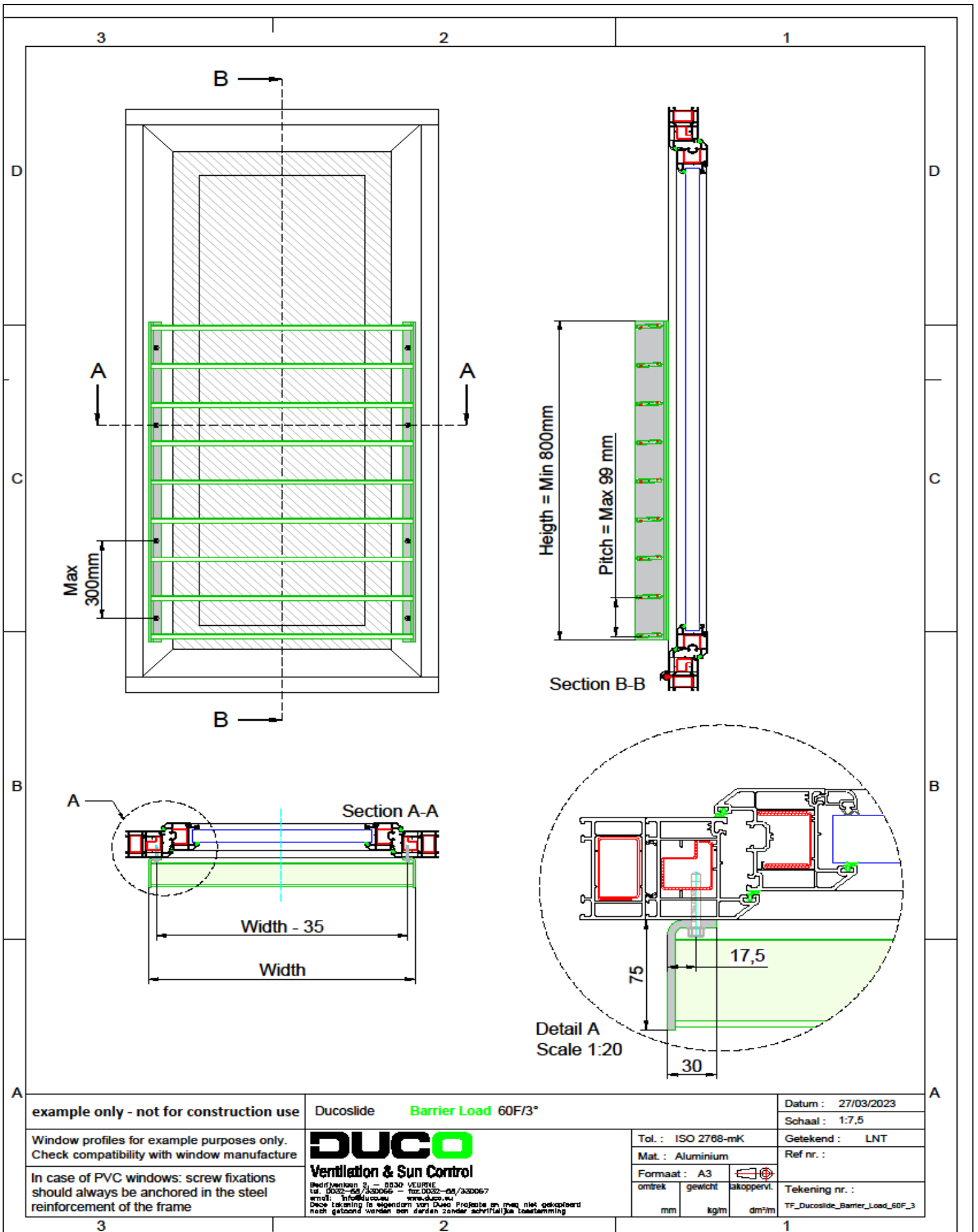

Type	Ducoslide Barrier Load 60F/3°
VISUAL FREE AREA	Fixed slide panel as barrier load for opening window
SHAPE OF BLADE	60F
BLADE INCLINATION	3°
PITCH	To specification barrier load, maximum pitch = 99 mm
FRAME WIDTH	30 mm
FRAME DEPTH	75 mm
MIN. DIMENSIONS	<ul style="list-style-type: none">- Width 250mm- Window openings: Height 800mm- Balconies: Height 1100mm
BARRIER LOAD	In accordance to BS 6180:2011
REACTION TO FIRE	A2-s1,d0 (EN13501-1)
MATERIAL	Aluminium : EN AW-6063 T66 (EN 573-3) Profile thickness : min. 1,5mm
SURFACE TREATMENT	<ul style="list-style-type: none">- polyester powder coated (60-80µm) according Qualicoat Seaside type A- specific RAL codes and/or textured paint on request



example only - not for construction use

Ducoslide **Barrier Load 60F/3°**

Datum : 27/03/2023

Schaal : 1:7,5

Window profiles for example purposes only.
Check compatibility with window manufacture

DUCO
Ventilation & Sun Control

Tol. : ISO 2788-mK

Getekend : LNT

Mat. : Aluminium

Ref nr. :

Formaat : A3



Tekening nr. :

In case of PVC windows: screw fixations
should always be anchored in the steel
reinforcement of the frame

Bedrijfsnaam: B - 0030 VEURNE
tel.: 0302-65/33066 fax: 0302-65/33067
email: info@duco.eu www.duco.eu
Deze tekening is eigendom van DUCO. Profiteer en mis niet, gekopieerd
noch getoond worden aan derden zonder schriftelijke toestemming

omtrek	gewicht	lakoppervl.
mm	kg/m	dm²/m

TF_Ducoslide_Barrier_Load_60F_3