

TECHNICAL DATA SHEET



| Type | DucoWall Classic W 50Z-75 | | | | | | | | | | | | | | | | | | | |
|--------------------|--|--|-----------|----------|-----------|-------|-----------------|-------|-----------|-------|------------------|-------|-----------|---|-------------|---|-----------|---|-------------|---|
| DESCRIPTION | Continuous louvre wall | | | | | | | | | | | | | | | | | | | |
| SHAPE OF BLADE | 50Z | | | | | | | | | | | | | | | | | | | |
| PITCH | 75 mm | | | | | | | | | | | | | | | | | | | |
| BLADE HEIGHT | 76 mm | | | | | | | | | | | | | | | | | | | |
| BLADE DEPTH | 53 mm | | | | | | | | | | | | | | | | | | | |
| INSTALLATION DEPTH | with mullion 50/125 178 mm with mullion 50/50 103 mm with mullion 50/12 65 mm with mullion 21/50 MULTI 103 mm with mullion 30/14 65 mm | | | | | | | | | | | | | | | | | | | |
| MAX. BLADE LENGTH | 6000 mm | | | | | | | | | | | | | | | | | | | |
| MAX. SPAN | 1550 mm @ 800Pa | | | | | | | | | | | | | | | | | | | |
| STARTING DIMENSION | 19 mm | | | | | | | | | | | | | | | | | | | |
| MESH | standard without insectmesh frame | | | | | | | | | | | | | | | | | | | |
| MATERIAL | Aluminium : EN AW-6063 T66 (EN 573-3) Profile thickness : min. 1,5mm Thermoplastic parts : Clips Polyamide PA 6,6 -reinforced with glass fibre | | | | | | | | | | | | | | | | | | | |
| SURFACE TREATMENT | - standard aluminium anodised (15-20µm) according Qualanod - polyester powder coated (60-80µm) according Qualicoat Seaside type A - specific RAL codes and/or textured paint on request | | | | | | | | | | | | | | | | | | | |
| VISUAL FREE AREA | 80% | | | | | | | | | | | | | | | | | | | |
| PHYSICAL FREE AREA | 54% | | | | | | | | | | | | | | | | | | | |
| AIR FLOW DATA | <table border="1"> <thead> <tr> <th>(EN13030)</th> <th>standard</th> </tr> </thead> <tbody> <tr> <td>Ce</td> <td>0,219</td> </tr> <tr> <td>K-factor intake</td> <td>20,85</td> </tr> <tr> <td>Cd</td> <td>0,297</td> </tr> <tr> <td>K-factor exhaust</td> <td>11,34</td> </tr> </tbody> </table> | | (EN13030) | standard | Ce | 0,219 | K-factor intake | 20,85 | Cd | 0,297 | K-factor exhaust | 11,34 | | | | | | | | |
| (EN13030) | standard | | | | | | | | | | | | | | | | | | | |
| Ce | 0,219 | | | | | | | | | | | | | | | | | | | |
| K-factor intake | 20,85 | | | | | | | | | | | | | | | | | | | |
| Cd | 0,297 | | | | | | | | | | | | | | | | | | | |
| K-factor exhaust | 11,34 | | | | | | | | | | | | | | | | | | | |
| WATER RESISTANCE | <table border="1"> <thead> <tr> <th>(EN13030)</th> <th>standard</th> </tr> </thead> <tbody> <tr> <td>v = 0 m/s</td> <td>B</td> </tr> <tr> <td>v =0,5 m/s</td> <td>C</td> </tr> <tr> <td>v = 1 m/s</td> <td>C</td> </tr> <tr> <td>v = 1.5 m/s</td> <td>D</td> </tr> <tr> <td>v = 2 m/s</td> <td>D</td> </tr> <tr> <td>v = 2.5 m/s</td> <td>D</td> </tr> <tr> <td>v = 3 m/s</td> <td>D</td> </tr> <tr> <td>v = 3,5 m/s</td> <td>D</td> </tr> </tbody> </table> | | (EN13030) | standard | v = 0 m/s | B | v =0,5 m/s | C | v = 1 m/s | C | v = 1.5 m/s | D | v = 2 m/s | D | v = 2.5 m/s | D | v = 3 m/s | D | v = 3,5 m/s | D |
| (EN13030) | standard | | | | | | | | | | | | | | | | | | | |
| v = 0 m/s | B | | | | | | | | | | | | | | | | | | | |
| v =0,5 m/s | C | | | | | | | | | | | | | | | | | | | |
| v = 1 m/s | C | | | | | | | | | | | | | | | | | | | |
| v = 1.5 m/s | D | | | | | | | | | | | | | | | | | | | |
| v = 2 m/s | D | | | | | | | | | | | | | | | | | | | |
| v = 2.5 m/s | D | | | | | | | | | | | | | | | | | | | |
| v = 3 m/s | D | | | | | | | | | | | | | | | | | | | |
| v = 3,5 m/s | D | | | | | | | | | | | | | | | | | | | |

3

2

1

D

D

C

C

B

B

A

A

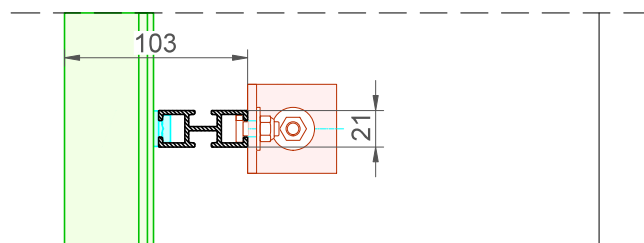
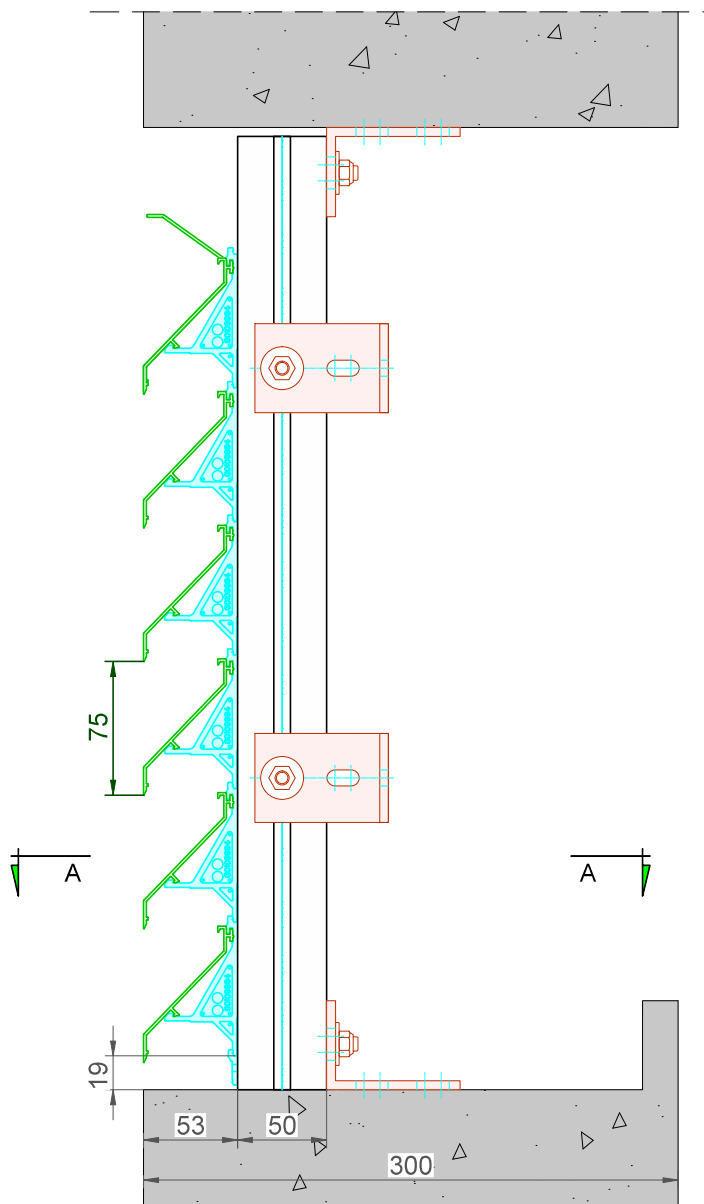

DucoWall Classic **50Z/75** Draagprofiel 21/50 Multi

Datum : 20/02/2023

Schaal : 1:3

DUCO
Ventilation & Sun Control

Bedrijvenlaan 2 - 8630 VEURNE
tel. 0032-58/330066 - fax.0032-58/330067
email: info@duco.eu www.duco.eu

Deze tekening is eigendom van Duco Projects en mag niet gekopieerd
noch getoond worden aan derden zonder schriftelijke toestemming

Tol. : ISO 2768-mK

Getekend : SVE/JHX

Mat. :

Ref nr. :

Formaat : A3



omtrek

gewicht

lakoppervl.

Tekening nr. :

mm

kg/m

dm²/m

DWClassic-50Z/75 DP 21/50 Multi

Zonder dorpel, met toplamel

3

2

1