

Fitting instructions

Silenzio ZR (AK)

L0004118 23/06/2021

CONTENTS

1. Fitting the PVC tube
2. Fitting the inside section
3. Fitting the outer section
4. Operation

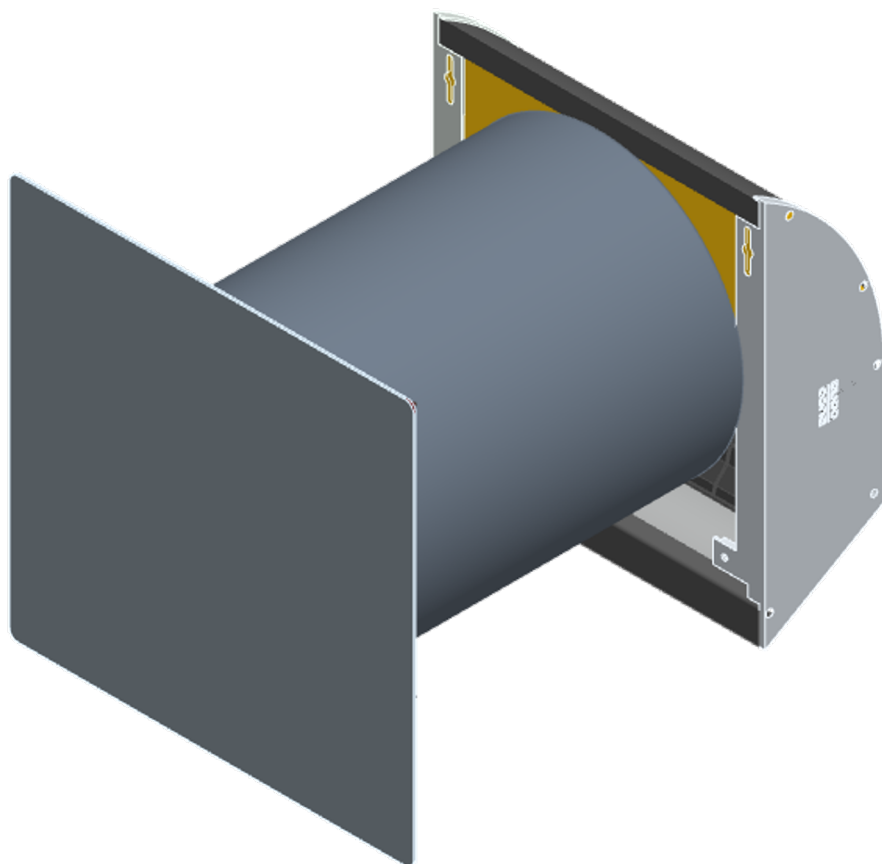

1 Fitting the PVC tube

1. Push the PVC tube together with the foam from the inside of the wall into the drilled hole with diameter 250mm. Make sure that the tube is flush with the inside of the inside wall. The length of the tube must not exceed the total wall thickness. Fit the tube so that both the inside and outside can be sealed.

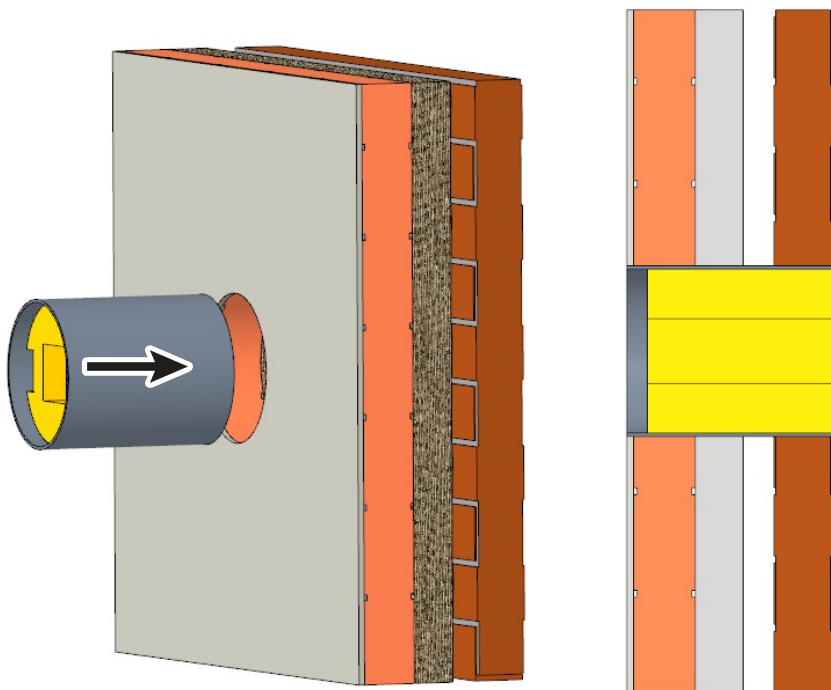

2. Fit the PVC tube as illustrated. The square in the foam should be aligned with the two recesses to left and right.

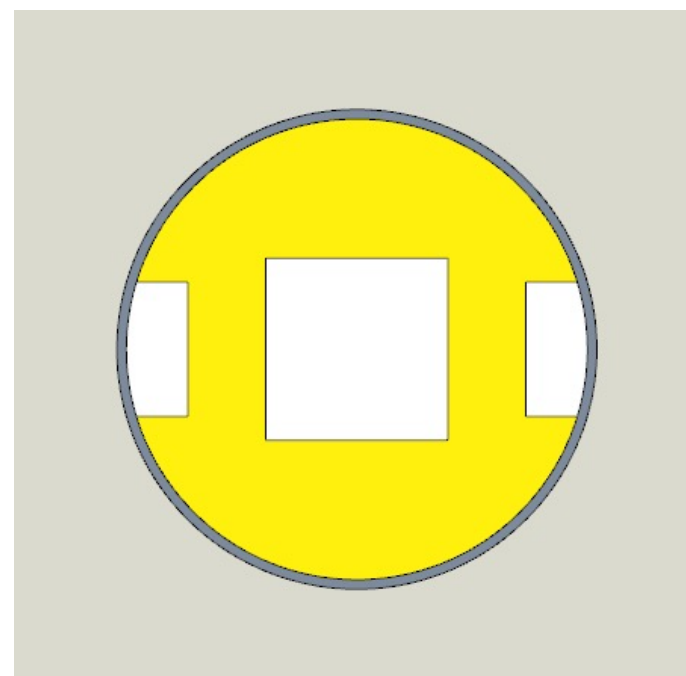

1 Fitting the PVC tube

3. Apply silicone to the joint between the PVC tube and the wall for a good seal.

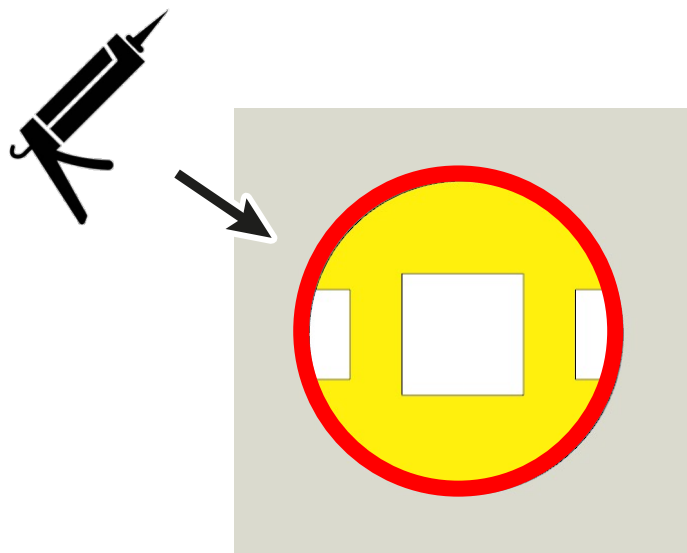

4. Resulting inner side after fitting the tube

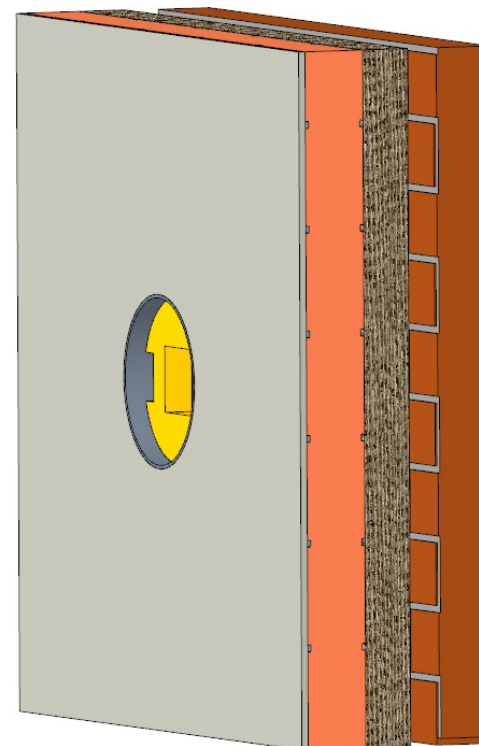

2 Fitting the inside section

1. Fit the folded aluminium plate with the previously fitted sleeve bearings in the PVC tube. Make the plate level and mark the 6 holes. Remove the plate and drill the 6 holes with diameter 6mm. Put the supplied 3x30 plugs in the drilled holes.

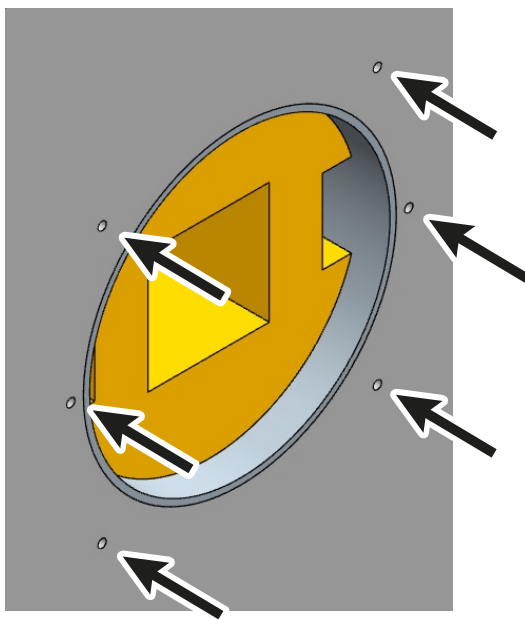

2. Put the plate back in the pipe and screw it tight with the supplied 4x38mm screws.

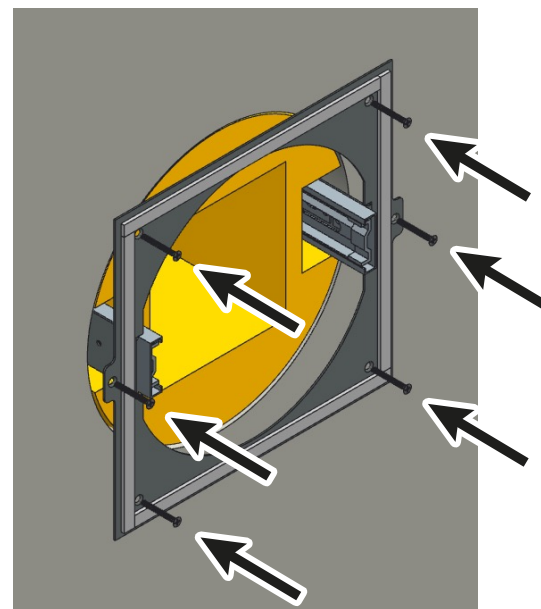

2 Fitting the inside section

3. Slide the trim plate with the previously fitted plastic parts and sections over the sleeve bearings.

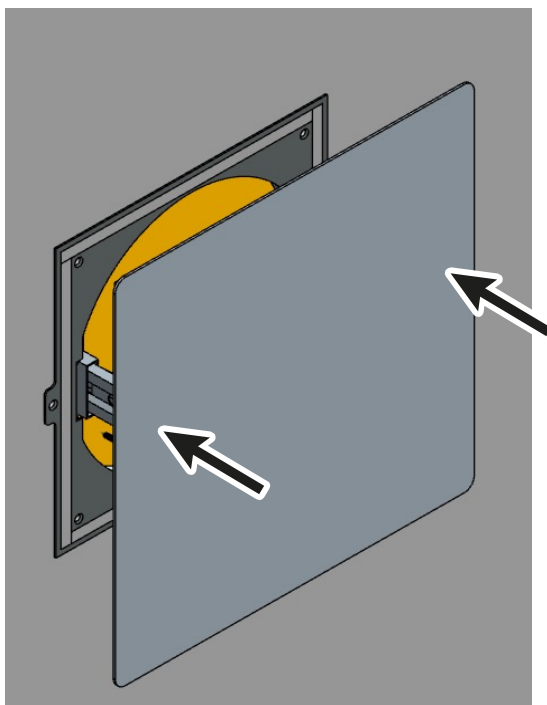

1. Apply silicone to the joint between the PVC tube and the wall for a good seal.

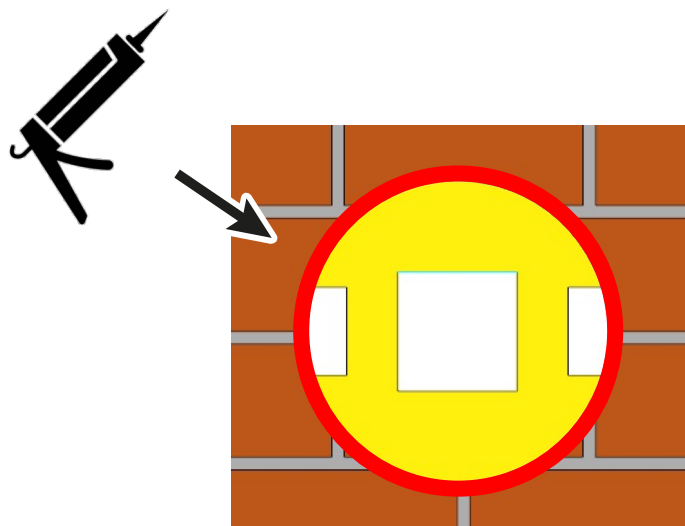

2. Glue the supplied template to the wall in order to mark out the drill holes. Follow the further instructions on this template or go to the next page.

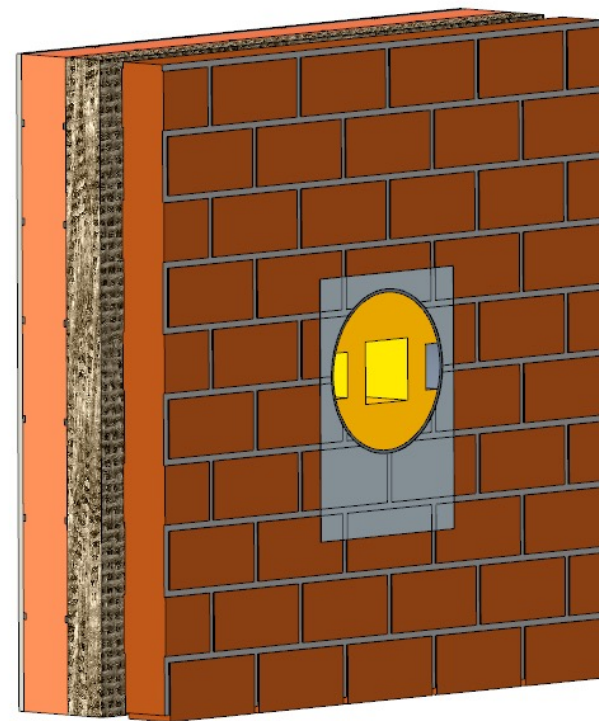

3 Fitting the outer section

3. Drill the screw holes according to the template of the 250mm pipe. Insert all the wall plugs into the drilled holes and insert the two top screws to within 1cm of the wall.

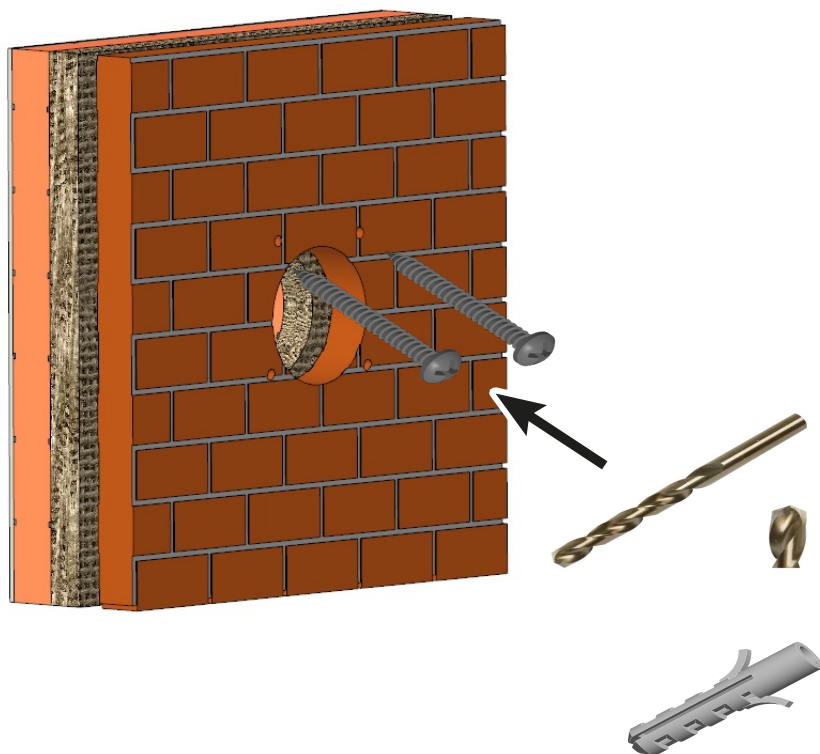

4. Place the Silenzio ZR with the opening in the upper grooves over the screws.

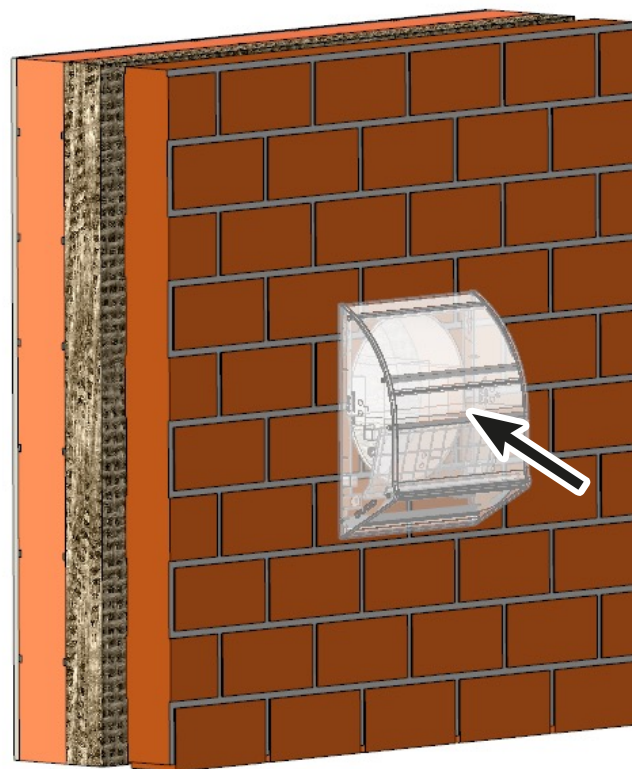

5. Carefully slide the Silenzio ZR downwards approximately 1.5cm.

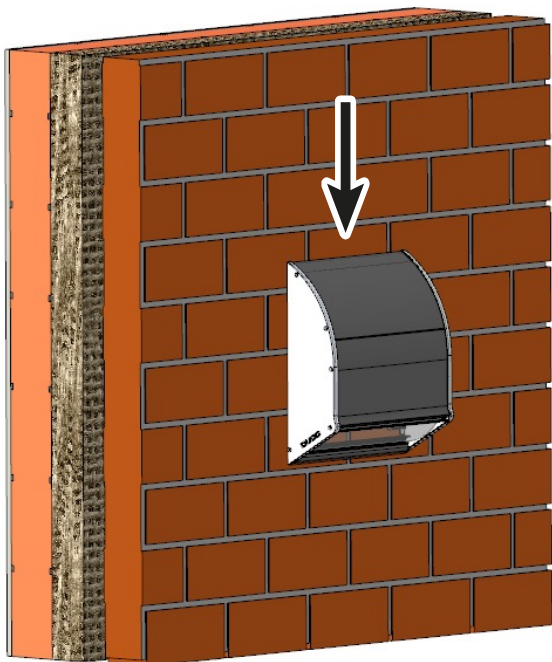

6. Fasten the bottom with 2 screws.

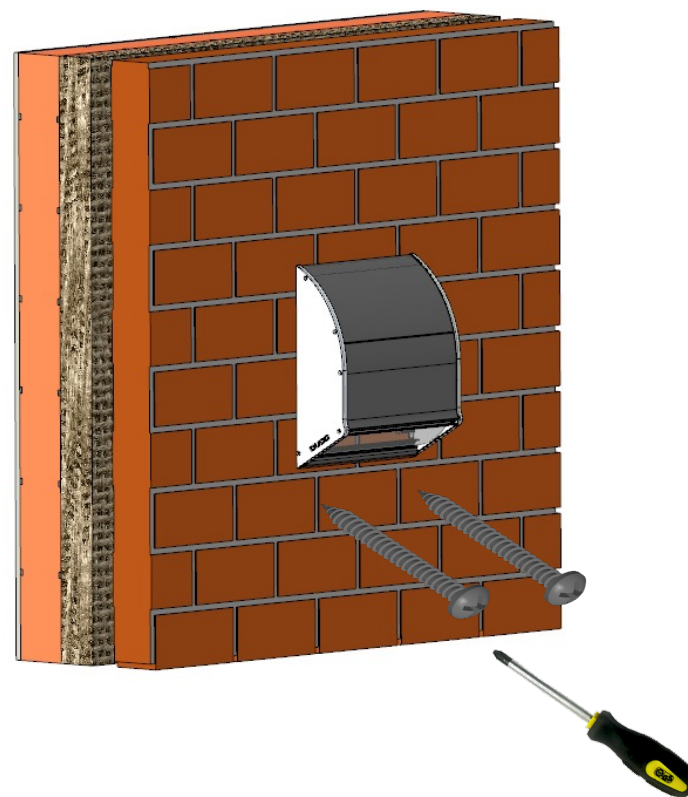

3 Fitting the outer section

7. Fix the insect mesh on the underside.

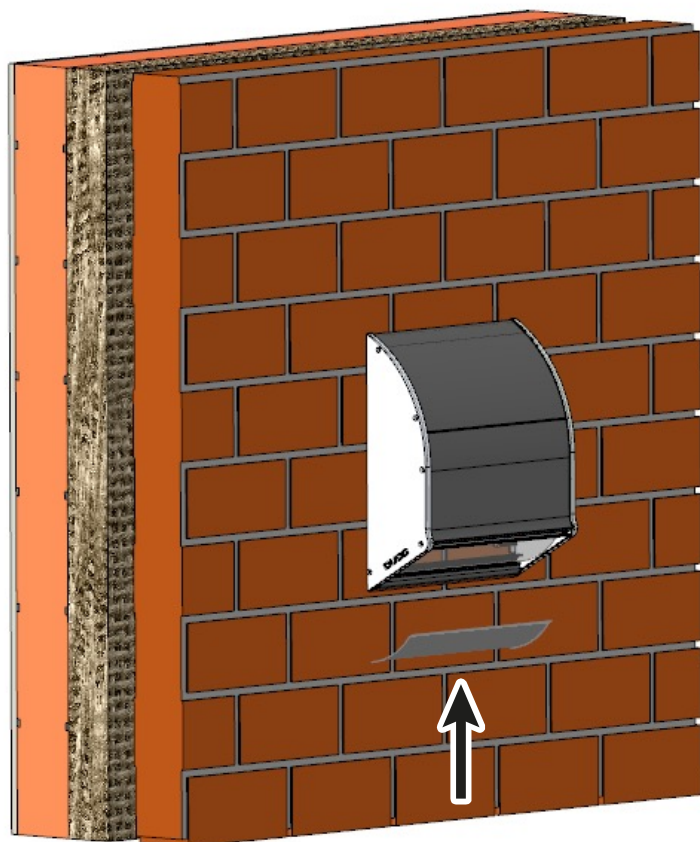

4

Operation

Shut

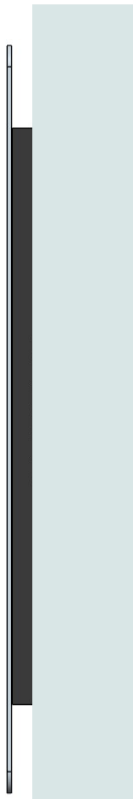

Open ≈ 35 mm

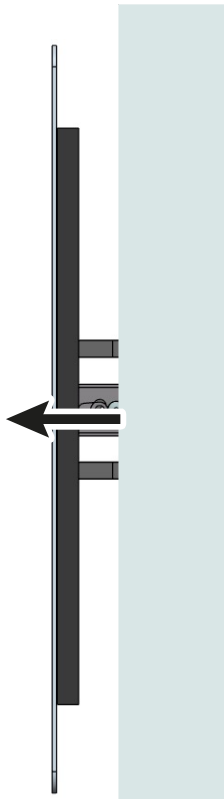

Pull harder to slide out completely.

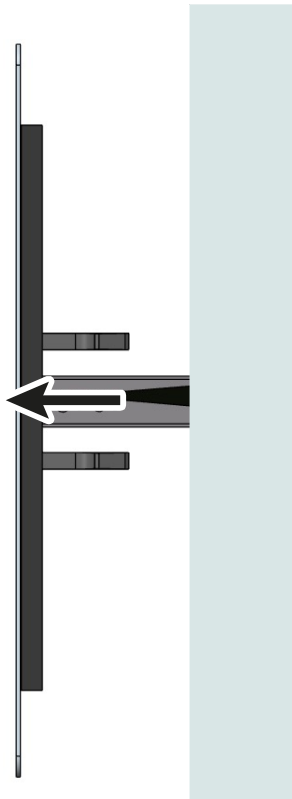

Push the black lever down or up (depending on L or R) to release.

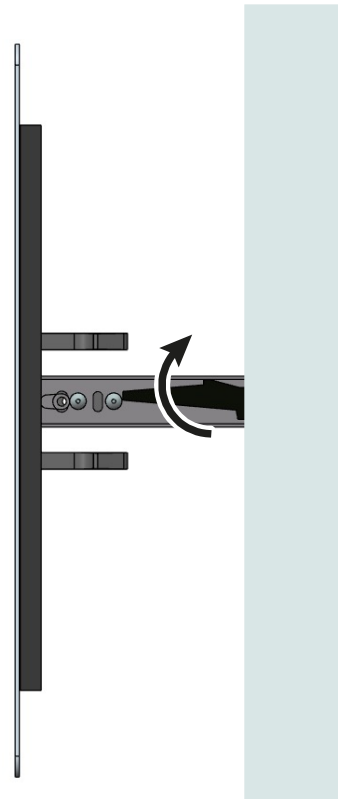

Operate by hand only at the points indicated by the arrows.

