

# TECHNICAL DATA SHEET



Type	DucoWall Classic W 35V																			
<b>DESCRIPTION</b>	Continuous louvre wall																			
<b>SHAPE OF BLADE</b>	35V																			
<b>PITCH</b>	35 mm																			
<b>BLADE HEIGHT</b>	39 mm																			
<b>BLADE DEPTH</b>	38 mm																			
<b>INSTALLATION DEPTH</b>	with mullion 50/125 163 mm with mullion 50/50 88 mm with mullion 50/12 50 mm with mullion 21/50 MULTI 88 mm																			
<b>MAX. BLADE LENGTH</b>	6000 mm																			
<b>MAX. SPAN</b>	2650 mm @ 800Pa																			
<b>STARTING DIMENSION</b>	20 mm																			
<b>MESH</b>	standard without insectmesh frame																			
<b>MATERIAL</b>	Aluminium : EN AW-6063 T66 (EN 573-3) Profile thickness : min. 1,2mm Thermoplastic parts : Clips Polyamide PA 6,6 -reinforced with glass fibre																			
<b>SURFACE TREATMENT</b>	- standard aluminium anodised (15-20µm) according Qualanod - polyester powder coated (60-80µm) according Qualicoat Seaside type A - specific RAL codes and/or textured paint on request																			
<b>VISUAL FREE AREA</b>	59%																			
<b>PHYSICAL FREE AREA</b>	35%																			
<b>AIR FLOW DATA</b>	<table border="1"> <thead> <tr> <th>(EN13030)</th> <th>standard</th> </tr> </thead> <tbody> <tr> <td>Ce</td> <td>0,118</td> </tr> <tr> <td>K-factor intake</td> <td>71,82</td> </tr> <tr> <td>Cd</td> <td>0,124</td> </tr> <tr> <td>K-factor exhaust</td> <td>65,04</td> </tr> </tbody> </table>		(EN13030)	standard	Ce	0,118	K-factor intake	71,82	Cd	0,124	K-factor exhaust	65,04								
(EN13030)	standard																			
Ce	0,118																			
K-factor intake	71,82																			
Cd	0,124																			
K-factor exhaust	65,04																			
<b>WATER RESISTANCE</b>	<table border="1"> <thead> <tr> <th>(EN13030)</th> <th>standard</th> </tr> </thead> <tbody> <tr> <td>v = 0 m/s</td> <td>A</td> </tr> <tr> <td>v = 0,5 m/s</td> <td>A</td> </tr> <tr> <td>v = 1 m/s</td> <td>A</td> </tr> <tr> <td>v = 1.5 m/s</td> <td>A</td> </tr> <tr> <td>v = 2 m/s</td> <td>C</td> </tr> <tr> <td>v = 2.5 m/s</td> <td>C</td> </tr> <tr> <td>v = 3 m/s</td> <td>D</td> </tr> <tr> <td>v = 3,5 m/s</td> <td>D</td> </tr> </tbody> </table>		(EN13030)	standard	v = 0 m/s	A	v = 0,5 m/s	A	v = 1 m/s	A	v = 1.5 m/s	A	v = 2 m/s	C	v = 2.5 m/s	C	v = 3 m/s	D	v = 3,5 m/s	D
(EN13030)	standard																			
v = 0 m/s	A																			
v = 0,5 m/s	A																			
v = 1 m/s	A																			
v = 1.5 m/s	A																			
v = 2 m/s	C																			
v = 2.5 m/s	C																			
v = 3 m/s	D																			
v = 3,5 m/s	D																			

3

2

1

D

D

C

C

B

B

A

A

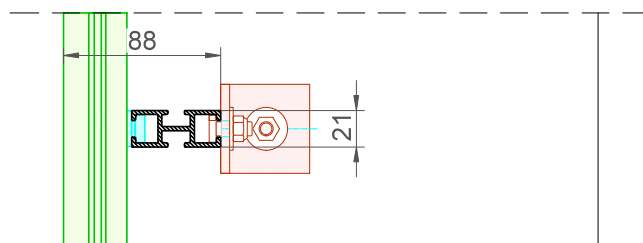
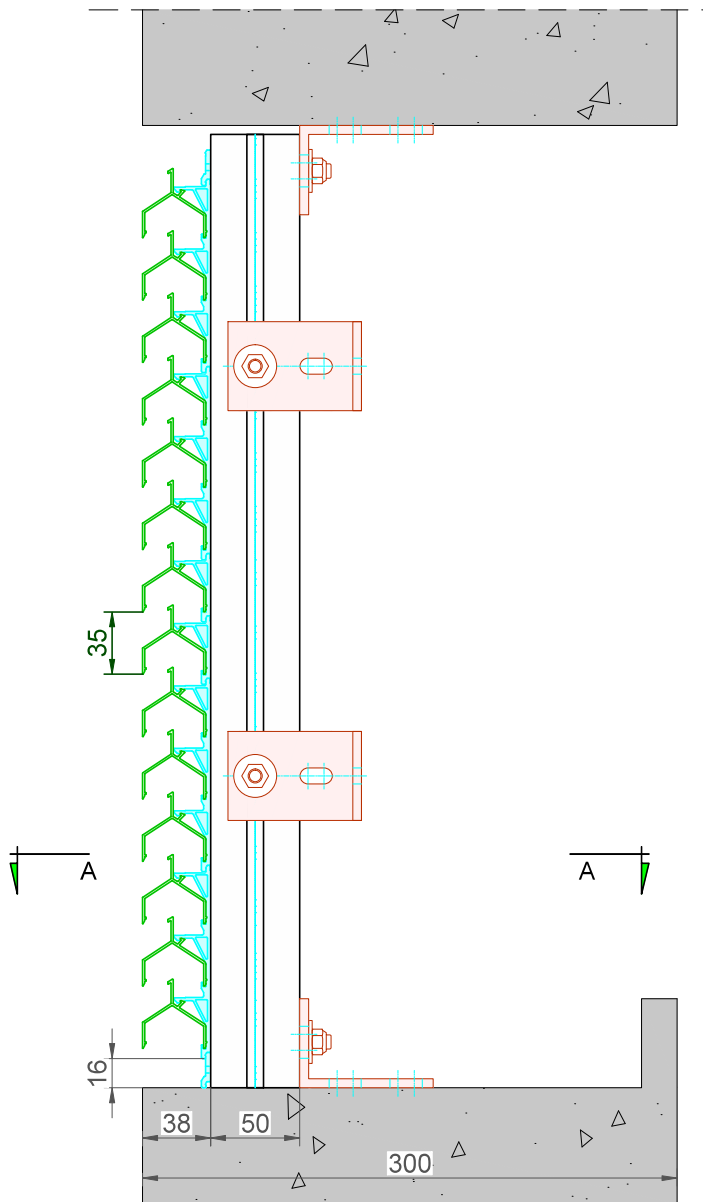

DucoWall Classic **35V** Draagprofiel 21/50 Multi

Datum : 20/02/2023

Schaal : 1:3

**DUCO**  
Ventilation & Sun Control

Tol. : ISO 2768-mK

Getekend : SVE/JHX

Mat. :

Ref nr. :

Formaat : A3



omtrek

gewicht

lakoppervl.

Tekening nr. :

Bedrijvenlaan 2 - 8630 VEURNE  
tel. 0032-58/330066 - fax.0032-58/330067  
email: info@duco.eu www.duco.eu  
Deze tekening is eigendom van Duco Projects en mag niet gekopieerd  
noch getoond worden aan derden zonder schriftelijke toestemming

DWClassic-35V DP 21/50 Multi

Zonder dorpel, geen toplamel beschikbaar

3

2

1