

TECHNICAL DATA SHEET



Duco Barrier Load Louvre - Slimframe 11/70 - 55°																			
Type	Fixed panel as barrier load																		
VISUAL FREE AREA	60F Barrier Load																		
SHAPE OF BLADE	60F Barrier Load																		
BLADE INCLINATION	55°																		
PITCH	To specification barrier load, maximum pitch = 100 mm																		
FRAME WIDTH	11 mm																		
FRAME DEPTH	70 mm																		
MIN. DIMENSIONS	- Width 100mm																		
MAX. DIMENSIONS	- Width 1000 mm																		
REACTION TO FIRE	A2-s1,d0 (EN13501-1)																		
MATERIAL	Aluminium : EN AW-6063 T66 (EN 573-3) Profile thickness : min. 1,5mm																		
SURFACE TREATMENT	- polyester powder coated (60-80µm) according Qualicoat Seaside type A - specific RAL codes and/or textured paint on request																		
IMPACT RESISTANCE	<table border="1" style="width: 100%; border-collapse: collapse;"> <thead> <tr> <th style="width: 30%;"></th> <th style="width: 35%; text-align: center;">Fixed on window frame</th> <th style="width: 35%; text-align: center;">Fixed on four corners</th> </tr> </thead> <tbody> <tr> <td style="text-align: center;">EN13049</td> <td style="text-align: center;">Class 5</td> <td style="text-align: center;">Pending</td> </tr> <tr> <td style="text-align: center;">NF P08-302</td> <td style="text-align: center;">Class H2</td> <td style="text-align: center;">Pending</td> </tr> <tr> <td style="text-align: center;">B03-004</td> <td style="text-align: center;">Class A/B/C4/D</td> <td style="text-align: center;">Pending</td> </tr> <tr> <td style="text-align: center;">NEN-EN1991-1-1</td> <td style="text-align: center;">Class A/B/C4/D</td> <td style="text-align: center;">Pending</td> </tr> <tr> <td style="text-align: center;">BS6180</td> <td style="text-align: center;">Class XI*</td> <td style="text-align: center;">Pending</td> </tr> </tbody> </table>		Fixed on window frame	Fixed on four corners	EN13049	Class 5	Pending	NF P08-302	Class H2	Pending	B03-004	Class A/B/C4/D	Pending	NEN-EN1991-1-1	Class A/B/C4/D	Pending	BS6180	Class XI*	Pending
	Fixed on window frame	Fixed on four corners																	
EN13049	Class 5	Pending																	
NF P08-302	Class H2	Pending																	
B03-004	Class A/B/C4/D	Pending																	
NEN-EN1991-1-1	Class A/B/C4/D	Pending																	
BS6180	Class XI*	Pending																	
FALL-TROUGH PROTECTION																			

* check calculation file for maximum pitch and width

3

2

1

D

D

C

C

B

B

A

A

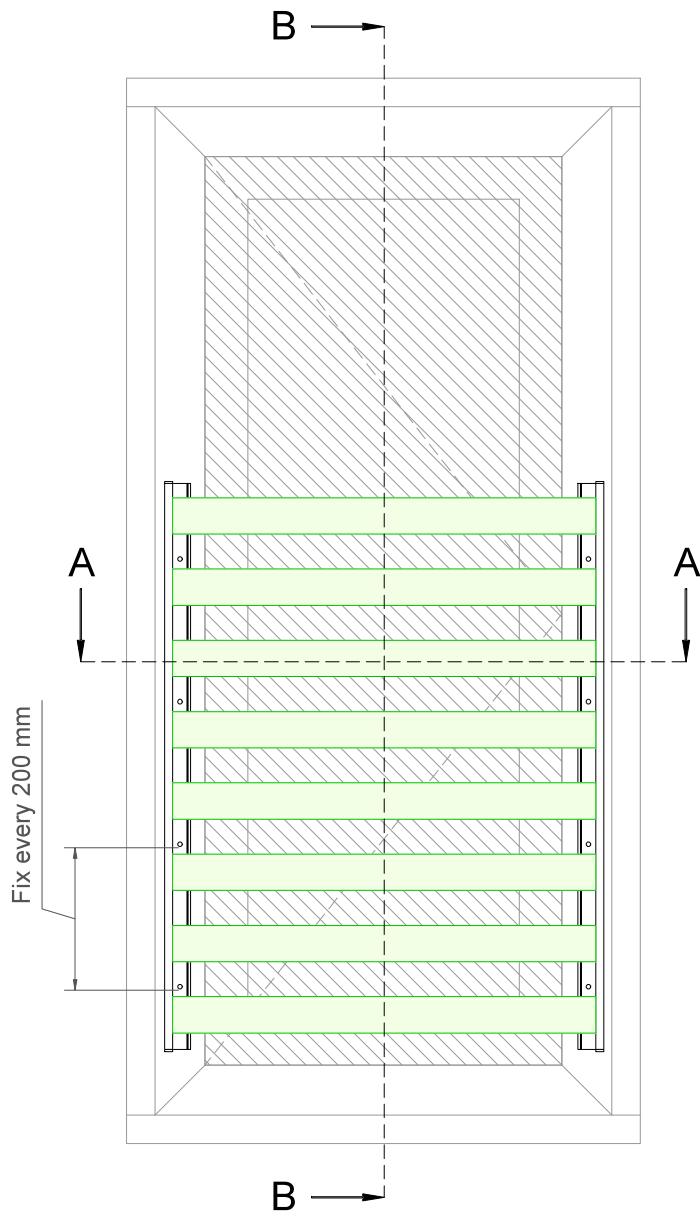

Section B-B

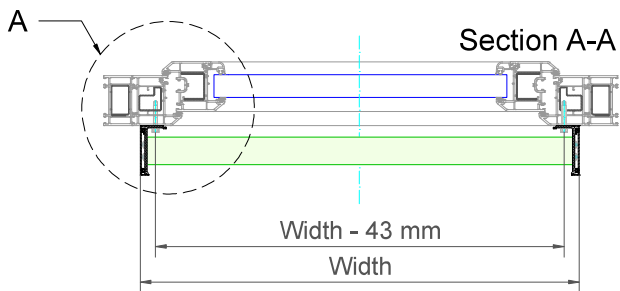
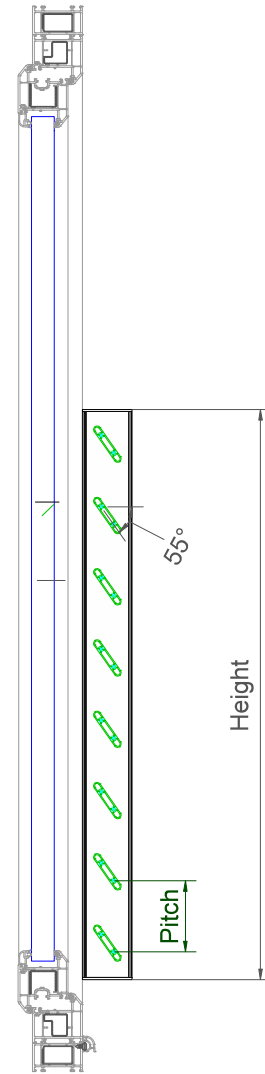

Section A-A

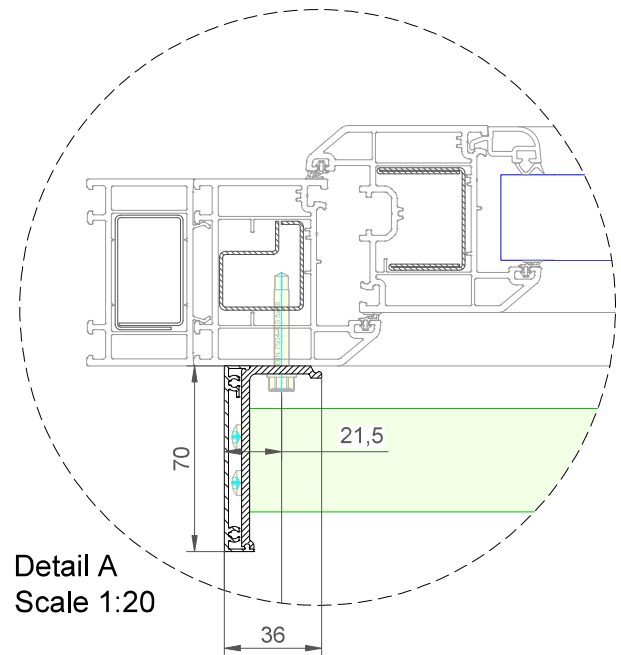
Detail A
Scale 1:20

example only - not for construction use

Duco Barrier Load Louvre - Slimframe 11-70 - 55°

Datum : 27/05/2024

Schaal : 1:7,5

Window profiles for example purposes only.
Check compatibility with window manufacturer

DUCO
Ventilation & Sun Control

Tol. : ISO 2768-mK

Getekend : RTN

Mat. : Aluminium

Ref nr. :

Formaat : A3



Tekening nr. :

In case of PVC windows: screw fixations
should always be anchored in the steel
reinforcement of the frame

Bedrijvenlaan 2, - 8630 VEURNE
tel. 0032-58/330066 - fax.0032-58/330067
email: info@duco.eu www.duco.eu
Deze tekening is eigendom van Duco Projects en mag niet gekopieerd
noch getoond worden aan derden zonder schriftelijke toestemming

omtrek

gewicht

lakoppervl.

Barrier Load Louvre - Slimframe 11-70 - 55°

mm

kg/m

dm²/m

3

2

1

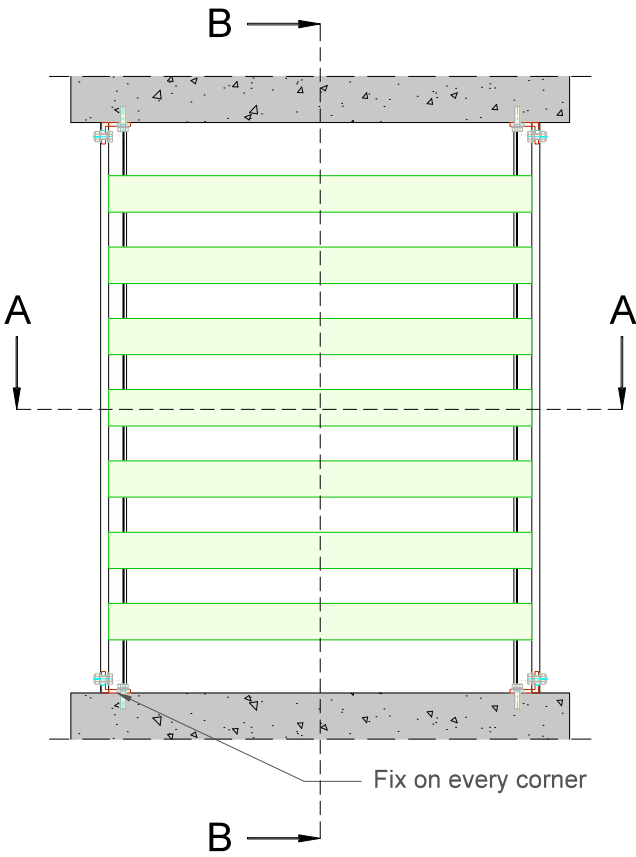

Section B-B

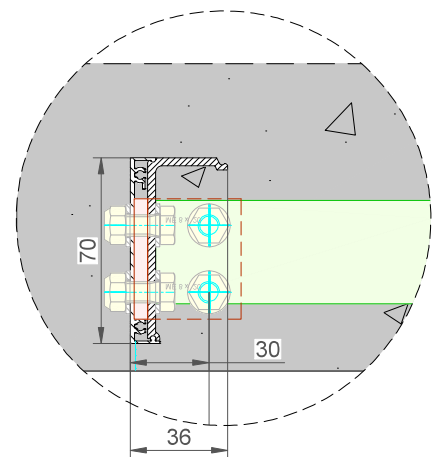
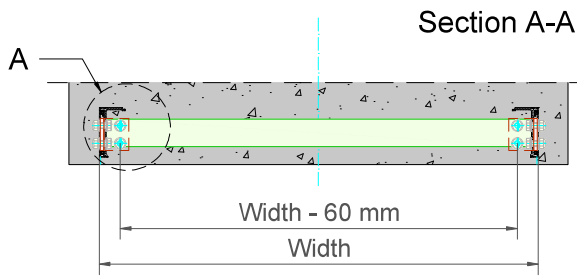
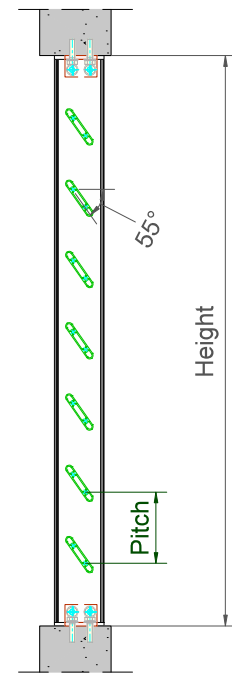

Detail A
Scale 1:20

example only - not for construction use

Duco Barrier Load Louvre - Slimframe 11-70 - 55° - In Dag

Datum : 27/05/2024

Schaal : 1:7,5

Window profiles for example purposes only.
Check compatibility with window manufacturer



Tol. : ISO 2768-mK

Getekend : RTN

Mat. : Aluminium

Ref nr. :

Formaat : A3



Tekening nr. :

In case of PVC windows: screw fixations
should always be anchored in the steel
reinforcement of the frame

Bedrijvenlaan 2, - 8630 VEURNE
tel. 0032-58/330066 - fax.0032-58/330067
email: info@duco.eu www.duco.eu
Deze tekening is eigendom van Duco Projects en mag niet gekopieerd
noch getoond worden aan derden zonder schriftelijke toestemming

omtrek

gewicht

lakoppervl.

Barrier Load Louvre - Slimframe 11-70 - 55° ID

mm

kg/m

dm²/m