

TECHNICAL DATA SHEET



Type	DucoGrille Classic F 20Z	
DESCRIPTION	Window louvre, applicable in aluminium, PVC or timber windows.	
SHAPE OF BLADE	20Z	
PITCH	35 mm	
FRAME WIDTH	26 mm	
GLASS THICKNESS	24 mm	
FRAME DEPTH	35 mm	
MIN. DIMENSIONS	Width 200mm, Height 200mm. Exception on request.	
MESH	<ul style="list-style-type: none"> - standard with insectmesh 2.3 x 2.3 mm - optional without mesh - optional with bird mesh 6 x 6 mm - optional with bird mesh 20 x 20 mm 	
DRIP TRAY PROFILE	not applicable	
MATERIAL	Aluminium : EN AW-6063 T66 (EN 573-3) Profile thickness : min. 1,5mm Thermoplastic parts : Clips Polyamide PA 6,6 -reinforced with glass fibre	
SURFACE TREATMENT	<ul style="list-style-type: none"> - standard aluminium anodised (15-20µm) according Qualanod - polyester powder coated (60-80µm) according Qualicoat Seaside type A - specific RAL codes and/or textured paint on request 	
VISUAL FREE AREA	63%	
PHYSICAL FREE AREA	41%	
AIR FLOW DATA	(EN13030)	standard
	Ce	0,203
	K-factor intake	24,27
	Cd	0,174
	K-factor exhaust	33,03
WATER RESISTANCE	(EN13030)	standard
	v = 0 m/s	C
	v = 0,5 m/s	C
	v = 1 m/s	C
	v = 1.5 m/s	D
	v = 2 m/s	D
	v = 2.5 m/s	D
	v = 3 m/s	D
	v = 3,5 m/s	D

3

2

1

D

D

C

C

B

B

A

A

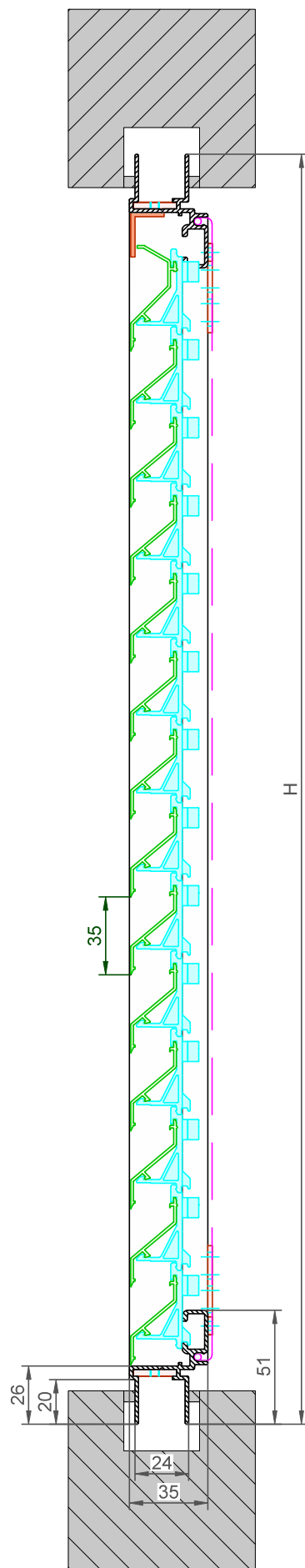
DucoGrille Classic **F20Z**

Datum : 14/02/2023

Schaal : 1:2

DUCO
Ventilation & Sun Control

Bedrijvenlaan 2 - 8630 VEURNE
tel. 0032-58/330066 - fax.0032-58/330067
email: info@duco.eu www.duco.eu
Deze tekening is eigendom van Duco Projects en mag niet gekopieerd
noch getoond worden aan derden zonder schriftelijke toestemming

Tol. : ISO 2768-mK

Getekend : SDN/JHX

Mat. :

Ref nr. :

Formaat : A3



omtrek

gewicht

lakoppervl.

Tekening nr. :

mm

kg/m

dm²/m**DGC-F20Z**

3

2

1