

TECHNICAL DATA SHEET



Type	DucoWall Classic W 50Z30° - 75																			
DESCRIPTION	Continuous louvre wall																			
SHAPE OF BLADE	50Z30°																			
PITCH	75 mm																			
BLADE HEIGHT	72 mm																			
BLADE DEPTH	53 mm																			
INSTALLATION DEPTH	with mullion 50/125 178 mm with mullion 50/50 103 mm with mullion 50/12 65 mm with mullion 21/50 MULTI 103 mm																			
MAX. BLADE LENGTH	6000 mm																			
MAX. SPAN	2050 mm @ 800Pa																			
STARTING DIMENSION	16 mm																			
MESH	standard without insectmesh frame																			
MATERIAL	Aluminium : EN AW-6063 T66 (EN 573-3) Profile thickness : min. 1,2mm Thermoplastic parts : Clips Polyamide PA 6,6 -reinforced with glass fibre																			
SURFACE TREATMENT	- standard aluminium anodised (15-20µm) according Qualanod - polyester powder coated (60-80µm) according Qualicoat Seaside type A - specific RAL codes and/or textured paint on request																			
VISUAL FREE AREA	49%																			
PHYSICAL FREE AREA	46%																			
AIR FLOW DATA	<table border="1"> <thead> <tr> <th>(EN13030)</th> <th>standard</th> </tr> </thead> <tbody> <tr> <td>Ce</td> <td>0,312</td> </tr> <tr> <td>K-factor intake</td> <td>10,27</td> </tr> <tr> <td>Cd</td> <td>0,339</td> </tr> <tr> <td>K-factor exhaust</td> <td>8,70</td> </tr> </tbody> </table>		(EN13030)	standard	Ce	0,312	K-factor intake	10,27	Cd	0,339	K-factor exhaust	8,70								
(EN13030)	standard																			
Ce	0,312																			
K-factor intake	10,27																			
Cd	0,339																			
K-factor exhaust	8,70																			
WATER RESISTANCE	<table border="1"> <thead> <tr> <th>(EN13030)</th> <th>standard</th> </tr> </thead> <tbody> <tr> <td>v = 0 m/s</td> <td>B</td> </tr> <tr> <td>v = 0,5 m/s</td> <td>C</td> </tr> <tr> <td>v = 1 m/s</td> <td>C</td> </tr> <tr> <td>v = 1.5 m/s</td> <td>C</td> </tr> <tr> <td>v = 2 m/s</td> <td>D</td> </tr> <tr> <td>v = 2.5 m/s</td> <td>D</td> </tr> <tr> <td>v = 3 m/s</td> <td>D</td> </tr> <tr> <td>v = 3,5 m/s</td> <td>D</td> </tr> </tbody> </table>		(EN13030)	standard	v = 0 m/s	B	v = 0,5 m/s	C	v = 1 m/s	C	v = 1.5 m/s	C	v = 2 m/s	D	v = 2.5 m/s	D	v = 3 m/s	D	v = 3,5 m/s	D
(EN13030)	standard																			
v = 0 m/s	B																			
v = 0,5 m/s	C																			
v = 1 m/s	C																			
v = 1.5 m/s	C																			
v = 2 m/s	D																			
v = 2.5 m/s	D																			
v = 3 m/s	D																			
v = 3,5 m/s	D																			

3

2

1

D

D

C

C

B

B

A

A

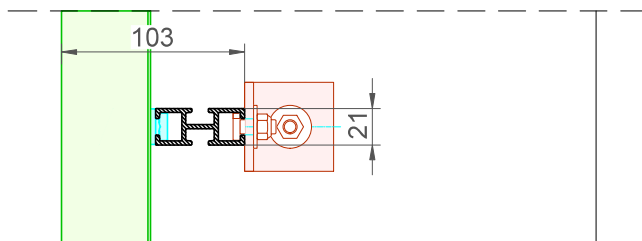
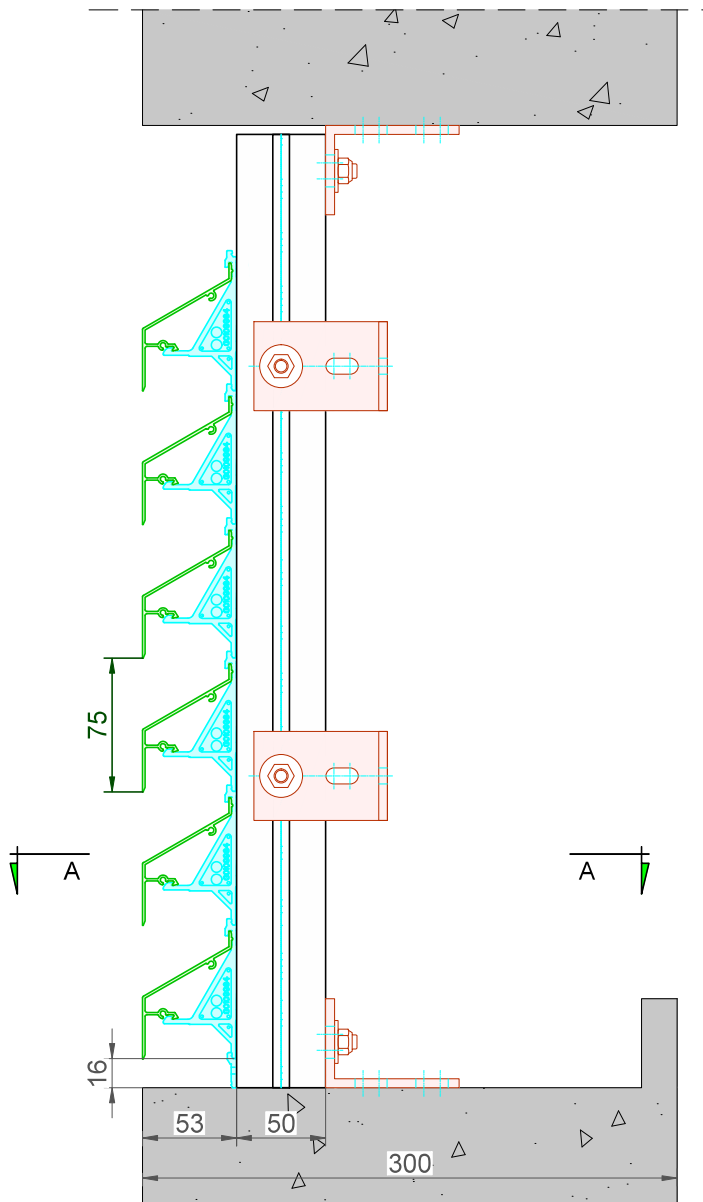

DucoWall Classic **50Z/30°/75 + Options** Draagprofiel 21/50 Multi

Datum : 20/02/2023

Schaal : 1:3

DUCO
Ventilation & Sun Control

Bedrijvenlaan 2 - 8630 VEURNE
tel. 0032-58/330066 - fax.0032-58/330067
email: info@duco.eu www.duco.eu

Deze tekening is eigendom van Duco Projects en mag niet gekopieerd noch getoond worden aan derden zonder schriftelijke toestemming

Tol. : ISO 2768-mK

Getekend : SVE/JHX

Mat. :

Ref nr. :

Formaat : A3



omtrek

gewicht

lakoppervl.

Tekening nr. :

mm

kg/m

dm²/m

DWClassic-50Z/30°/75 DP 21/50 Multi

Zonder dorpel, geen toplamel beschikbaar

3

2

1