

TECHNICAL DATA SHEET



Type	DucoWall Classic W 70V + options																			
DESCRIPTION	Continuous louvre wall																			
SHAPE OF BLADE	70V																			
PITCH	65 mm																			
BLADE HEIGHT	71 mm																			
BLADE DEPTH	75 mm																			
INSTALLATION DEPTH	<table border="0"> <tr> <td>with mullion 50/125</td> <td>200 mm</td> </tr> <tr> <td>with mullion 50/50</td> <td>125 mm</td> </tr> <tr> <td>with mullion 50/12</td> <td>87 mm</td> </tr> <tr> <td>with mullion 21/50 MULTI</td> <td>125 mm</td> </tr> </table>		with mullion 50/125	200 mm	with mullion 50/50	125 mm	with mullion 50/12	87 mm	with mullion 21/50 MULTI	125 mm										
with mullion 50/125	200 mm																			
with mullion 50/50	125 mm																			
with mullion 50/12	87 mm																			
with mullion 21/50 MULTI	125 mm																			
MAX. BLADE LENGTH	6000 mm																			
MAX. SPAN	2160 mm @ 800Pa																			
STARTING DIMENSION	24 mm																			
OPTIONS	Insectmesh frame 2,3 x 2,3mm included test result situation installed in wall																			
MATERIAL	<table border="0"> <tr> <td>Aluminium :</td> <td>EN AW-6063 T66 (EN 573-3)</td> </tr> <tr> <td></td> <td>Profile thickness : min. 1,5mm</td> </tr> <tr> <td>Thermoplastic parts :</td> <td>Clips</td> </tr> <tr> <td></td> <td>Polyamide PA 6,6 -reinforced with glass fibre</td> </tr> </table>		Aluminium :	EN AW-6063 T66 (EN 573-3)		Profile thickness : min. 1,5mm	Thermoplastic parts :	Clips		Polyamide PA 6,6 -reinforced with glass fibre										
Aluminium :	EN AW-6063 T66 (EN 573-3)																			
	Profile thickness : min. 1,5mm																			
Thermoplastic parts :	Clips																			
	Polyamide PA 6,6 -reinforced with glass fibre																			
SURFACE TREATMENT	<ul style="list-style-type: none"> - standard aluminium anodised (15-20µm) according Qualanod - polyester powder coated (60-80µm) according Qualicoat Seaside type A - specific RAL codes and/or textured paint on request 																			
VISUAL FREE AREA	65%																			
PHYSICAL FREE AREA	44%																			
AIR FLOW DATA	<table border="1"> <thead> <tr> <th>(EN13030)</th> <th>+ options</th> </tr> </thead> <tbody> <tr> <td>Ce</td> <td>0,111</td> </tr> <tr> <td>K-factor intake</td> <td>81,16</td> </tr> <tr> <td>Cd</td> <td>0,103</td> </tr> <tr> <td>K-factor exhaust</td> <td>94,26</td> </tr> </tbody> </table>		(EN13030)	+ options	Ce	0,111	K-factor intake	81,16	Cd	0,103	K-factor exhaust	94,26								
(EN13030)	+ options																			
Ce	0,111																			
K-factor intake	81,16																			
Cd	0,103																			
K-factor exhaust	94,26																			
WATER RESISTANCE	<table border="1"> <thead> <tr> <th>(EN13030)</th> <th>+ options</th> </tr> </thead> <tbody> <tr> <td>v = 0 m/s</td> <td>A</td> </tr> <tr> <td>v = 0,5 m/s</td> <td>B</td> </tr> <tr> <td>v = 1 m/s</td> <td>B</td> </tr> <tr> <td>v = 1.5 m/s</td> <td>C</td> </tr> <tr> <td>v = 2 m/s</td> <td>D</td> </tr> <tr> <td>v = 2.5 m/s</td> <td>D</td> </tr> <tr> <td>v = 3 m/s</td> <td>D</td> </tr> <tr> <td>v = 3,5 m/s</td> <td>D</td> </tr> </tbody> </table>		(EN13030)	+ options	v = 0 m/s	A	v = 0,5 m/s	B	v = 1 m/s	B	v = 1.5 m/s	C	v = 2 m/s	D	v = 2.5 m/s	D	v = 3 m/s	D	v = 3,5 m/s	D
(EN13030)	+ options																			
v = 0 m/s	A																			
v = 0,5 m/s	B																			
v = 1 m/s	B																			
v = 1.5 m/s	C																			
v = 2 m/s	D																			
v = 2.5 m/s	D																			
v = 3 m/s	D																			
v = 3,5 m/s	D																			

3

2

1

D

D

C

C

B

B

A

A

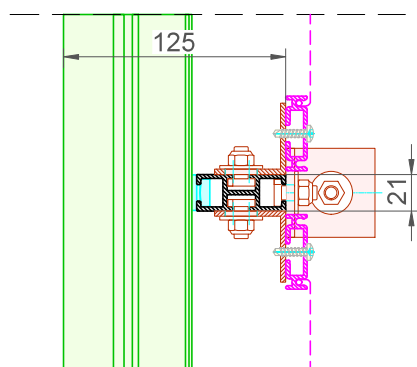
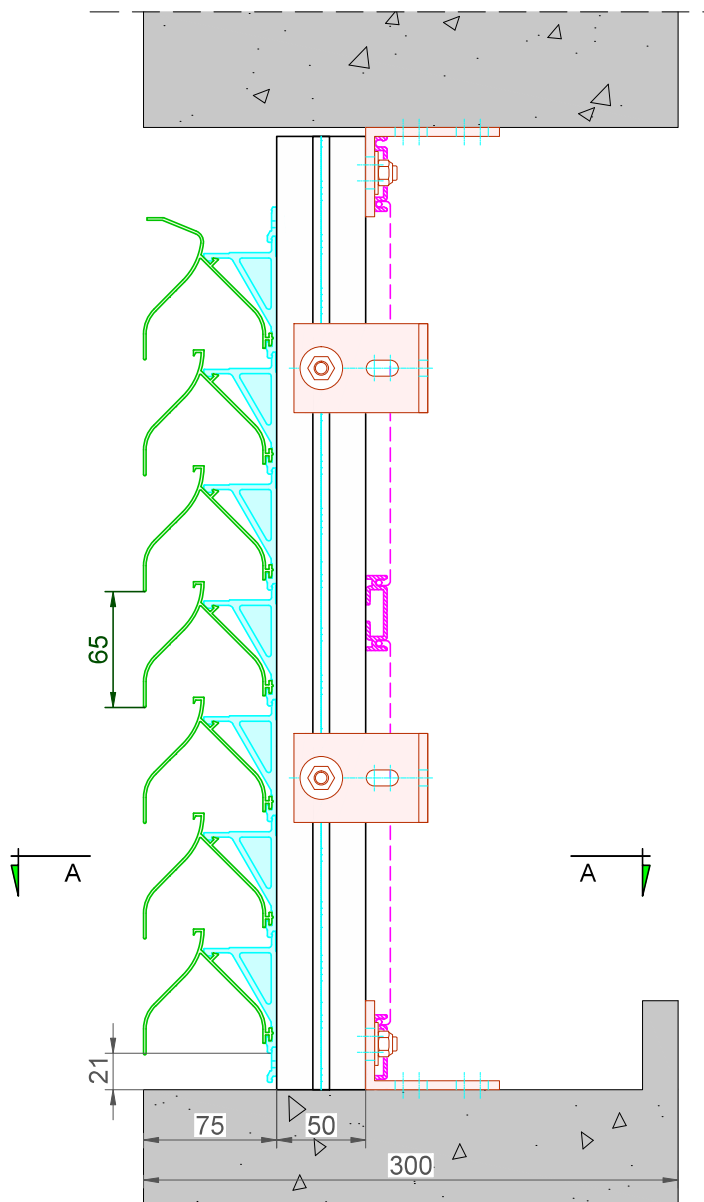
DucoWall Classic **70V + Options**

Draagprofiel 21/50 Multi

Datum : 20/02/2023

Schaal : 1:3

DUCO
Ventilation & Sun Control

Bedrijvenlaan 2 - 8630 VEURNE
tel. 0032-58/330066 - fax.0032-58/330067
email: info@duco.eu www.duco.eu

Deze tekening is eigendom van Duco Projects en mag niet gekopieerd
noch getoond worden aan derden zonder schriftelijke toestemming

Tol. : ISO 2768-mK

Getekend : SVE/JHX

Mat. :

Ref nr. :

Formaat : A3



omtrek

gewicht

lakoppervl.

Tekening nr. :

DWClassic-70V DP 21/50 Multi + Options

Zonder dorpel, met toplamel

3

2

1